

mesm
TOKYO

AUTOGRAPH COLLECTION®
HOTELS



TOKYO WAVES

mesm Tokyo is an innovative lifestyle hotel uniquely crafted for individualists. mesm Tokyo proudly showcases exceptional Japanese quality and welcomes guests to the cutting-edge style and trends of Tokyo.

1

mesm Tokyo

mesm Tokyo, Autograph Collection is aiming to become an icon of urban luxury hotel in Tokyo, where is constantly evolving new style among traditional and innovation together. Not only formal, but also proficient hospitality will be provided in the public area filled with inspiration and a playful spirit.

Bringing "Kando" through the interior design, the spirit of the dazzling metropolis that keeps mesmerizing all the guests is what mesm Tokyo offers as hotel experience. Moreover, animated by magnificent view of the metropolis below the restaurant will open your eyes and allow you to feel the heartbeat of the urban city.

2

Introduction of town

The area, Hamamatsucho/Takeshiba is located in central Tokyo, with great accessibility to Tokyo's airports and rail terminals, Tokyo Station, Shinagawa Station, and Haneda airport. Despite its location in the metropolitan Tokyo, the area is close to the open waterfront and adjacent to the nature and greenery of Hama-rikyu Gardens, a traditional Japanese garden originally created for Shogunate in the Edo era (1603-1868) and the dazzling city view of Tokyo.

3

WATERS takeshiba

WATERS takeshiba is located in the Hamamatsucho / Takeshiba district of the Tokyo Bay area, which serves as a hub linking Tokyo's central economic district with its waterfront. mesm Tokyo, Autograph Collection, shopping areas, offices, and The Shiki-theaters will all be here in 2020 for a unique experience which will be exactly like nothing else. WATERS takeshiba embraces attracting views of Hama-rikyu Gardens and the dazzling city view of Tokyo. You are in close proximity to entertainment, art and culture, whilst also appreciating the natural environment and rich greenery.

mesm
TOKYO

AUTOGRAPH COLLECTION[®]
HOTELS

mesm Tokyo,
Autograph Collection

1-10-30 Kaigan, Minato-ku,
Tokyo, 105-0022

T 03.5777.1111

F 03.5777.1155

www.marriott.com/tyoam

guest rooms & suites

The hotel features 265 excellently appointed rooms including suites with a magnificent view of the Hama-rikyu Garden.

[Guest Rooms]

chapter 1 (40sqm / 430sqft) ————— 1 6 6 rooms
chapter 2 (43~44sqm / 463~473sqft) ——— 91 rooms
chapter 3 suite (95sqm / 1022sqft) ————— 7 rooms
chapter 4 suite luxe (180sqm / 1937sqft) ——— 1 room

[Bed Size]

King bed : 180 x 203cm

Twin bed : 135 x 203cm



Bath amenities, Free Wi-Fi access, 55inch internet TV,
Mini bar, Electronic Piano, Tablet

location

mesm Tokyo, Autograph Collection is located at "WATERS takeshiba". The hotel embraces attracting views of Hama-rikyu Gardens and Tokyo Bay.

[Access by Train]

- 6 mins walk from Hamamatsucho Station on JR Yamanote Line / Keihin-Tohoku Line / Monorail
- 3 mins walk from Takeshiba Station on New Transit Yurikamome
- 7 mins walk from Daimon Station on Toei Oedo Line / Asakusa Line

※ 20 mins from Haneda Airport to Hamamatsucho Station by Monorail
※ 80 mins from Narita Airport to Hamamatsucho Station

[Access by Car]

5 mins from Inner Circular Route Shibakoen Exit / Shiodome Exit

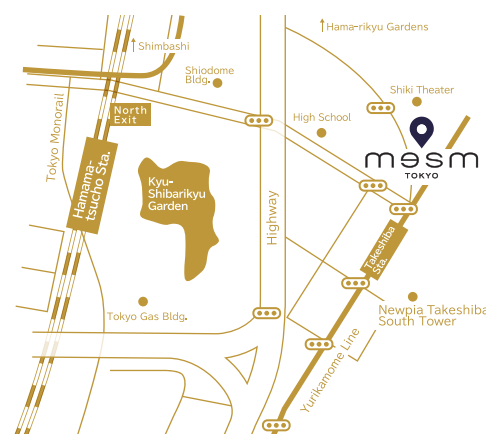

16th lobby floor plan

restaurant

Chef's Theatre

offering authentic French dishes in "bistronomy" style.

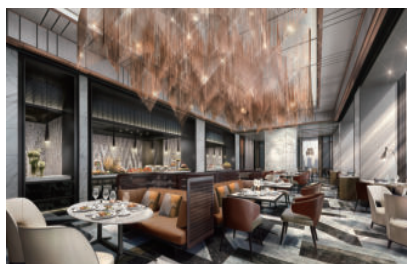

bar & lounge

Whisk

offering selected meals and original mixology cocktails.



banquet

Area ————— 1 8 0 m²
Dinner ————— 6 4 guests
Reception ————— 9 0 guests
Classroom ————— 6 0 guests
Theater ————— 7 8 guests

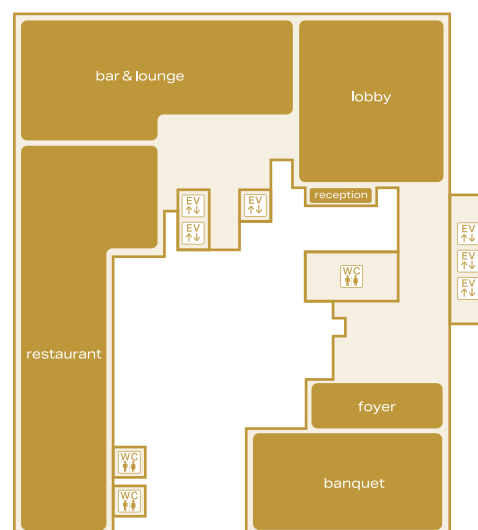

April 27, 2020. GRAND OPEN