

Welcome to North Mitaka

On the north side of Mitaka Station is a concentration of government offices to support residents' lives, and culture and sports facilities available to all, young and old alike. The area boasts many spots for relaxation and strolls, including Tokyo Municipal Musashino Chuo Park and Tamagawa Josui Canal. Here you can spend a leisurely time, relaxing as you please.

The area is also known as the past home of Nakajima Aircraft Company. Founded in 1917 by Chikuhai Nakajima, the company was one of the leading Japanese companies in the military aircraft industry prior to Japan's defeat. Between 1938 and 1945, the company produced engines in factories that spanned a vast area from the current Midoricho to Yahatacho in Musashino.

Best Spots



Musashino Chuo Park

Musashino Chuo Park is located nearly in the center of Musashino. The site had been used for military factories before the war and for U.S. military housing afterward, but was eventually reborn as a park through the longstanding wishes of local residents. It is now a place for relaxation of all kinds, centered on its large open field and its sports grounds.

Tamagawa Josui Canal

This aqueduct was built in 1653 over a length of 43 km from the modern Tokyo city of Hamura to Yotsuya in Shinjuku Ward, to supply drinking water throughout Edo (the old name of Tokyo). Even now, a portion of the aqueduct is operated by the Tokyo Metropolitan Government Bureau of Waterworks as a waterworks facility. A pedestrian walkway runs alongside the aqueduct, letting people enjoy the murmur of running water as they enjoy strolls among green trees.



Cherry Tree Row (Chuo-dori)

This outstanding row of cherry trees runs from near the intersection of Chuo-dori and Itsukaichi-kaido Avenue to the intersection of Shiritu Daiyon Junior High School, and along the street to the north of City Hall. When in full bloom, the trees appear to form a spectacular tunnel of blossoms. A Cherry Blossom Festival is held on the first Sunday of every April.

Green Park Path

This path, running along Tamagawa Josui Canal on the east side of the Sakai Purification Plant and up to the main entrance of Chuo Park, was built on the remnants of the former Japanese National Railways Musashino Stadium Line (from Mitaka Station to near the entrance of Musashino Chuo Park). Visitors can enjoy the changes of nature through the seasons on their walks.

Food, Dining and Cafe



- 1 Oyasai Bistro Shiawase**
This tasteful and cozy restaurant is committed to fresh vegetables that provide the finest taste. Guests are treated to perfectly cooked dishes, both Japanese and Western.
- 2 Kaomangai Bazaar**
Here you can enjoy authentic Thai cuisine, featuring rare dishes and Thai beer. All dishes are homemade with plenty of healthy and beauty-enhancing spices.
- 3 Nishikubo Shokudo**
This restaurant uses natural soup stock and additive-free seasonings. Japanese-style set meals with grilled fish, meat, and other items, together with rice, miso soup, and a small side dish, are available.
- 4 NICUTA**
This restaurant features steaks, hamburger steak, and other meat dishes. A set menu with rice and salad bars is available at lunch time. At dinner time, enjoy a range of meat dishes and reasonably priced wines.



- 5 Café terrasse verte**
Enjoy delicious food in a comfortable and tasteful interior. The airy terrace is open to guests with dogs.
- 6 Esprit de Paris**
This shop for Western sweets is located in a peaceful residential neighborhood. The confections are loved by local customers of all ages. Masterpieces of the chef's dedication, their moderate sweetness draws out the flavor of the ingredients.
- 7 Blue Bird**
This restaurant offers five types of curry, including chicken, dry, and green. Served with salad and homemade pickles, the curries are hits with customers young and old, men and women. The coffee is brewed using authentic flannel drip. The homemade desserts are recommended as well.
- 8 MIDOLINO**
The shared kitchen MIDOLINO operates under the theme of heartfelt food made with care and commitment. This "support facility for the creation of food with heart" supports people who create new businesses, as they gain practical experience in production and sales.



Enjoy nature, and walking about the town!

Musashino city, North Mitaka, Musashisakai!

Area Map

Scan the QR code on the spots! to check out information about the town!

English

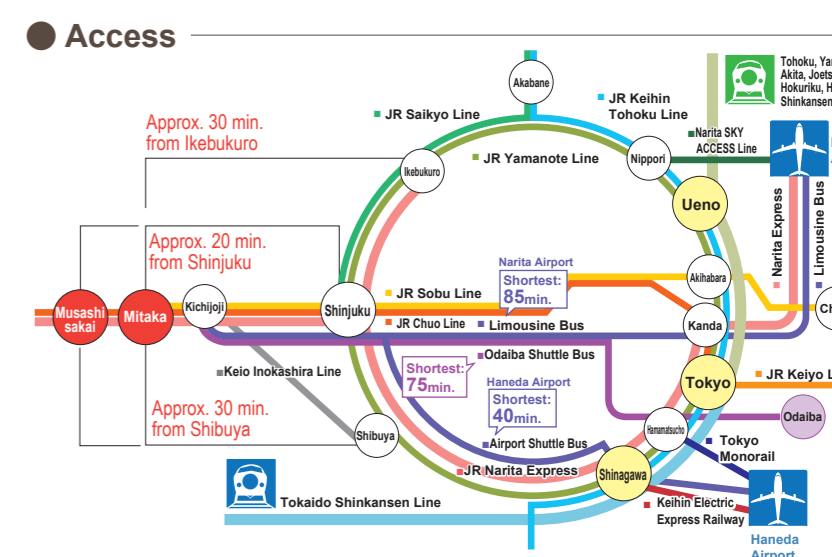

- ### Accommodation
- Mitaka**
 - Richmond Hotels Tokyo Musashino**
2-4-1 Naka-cho, Musashino-shi, Tokyo ☎0422-36-0022
 - Mitaka City Hotel**
3-21-5 Shimorenjaku, Mitaka-shi, Tokyo ☎0422-48-4111
 - Musashisakai**
 - atrevie MITAKA**
3-4-4 Shimorenjaku, Mitaka-shi, Tokyo ☎0422-76-6060
 - ito Yokado Musashisakai Branch**
2-2-20 Kyonan-cho, Musashino-shi, Tokyo ☎0422-31-2111
 - Emio Musashisakai**
2-1-12 Kyonan-cho, Musashino-shi, Tokyo
 - nonowa Musashisakai**
2-1-28 Kyonan-cho, Musashino-shi, Tokyo

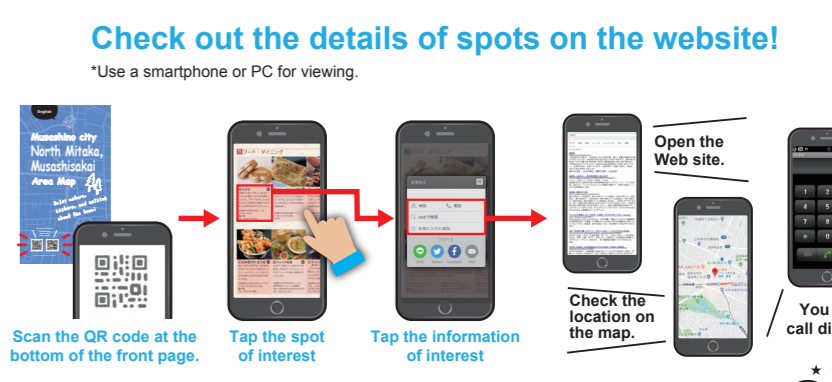

Welcome to Musashisakai

With the completion of a project for raised intersections at railway crossings, the area around the newly connected north and south areas of the station is undergoing development and has greatly changed. The impact of multiple universities and cultural facilities is spurring the location's evolution into an area for learning, where cultural and academic activities flourish in many domains. The surrounding residential neighborhoods have expanded, bordering Koganei Park to the west.

Best Spots and Public Facilities



Agriculture Fureai Park 0-1
This new, urban-style park brings agriculture into a park space. Local citizens conduct hands-on agricultural experiences and events in the park, which also features a relocated and restored nagayamon building thought to date back to the late Edo Period.



Furuse Park 0-2
This atmospheric Japanese-style park is thickly covered with pine and cherry trees around its pond. Visitors can enjoy Shoroon, an authentic tearoom reconstructed from the summer home of the Furuse family built at the start of the Showa Era. The room is used now for *sado* (tea ceremony), *kafo* (flower arrangement), *kukai* (haiku poetry gatherings), and more.



Kizuki Taisha Shrine 0-4
In the early Edo period, Matsudaira Naomasa, who maintained a *daimyo* summer residence on the site, built Kizuki-Taisha Shrine (currently Izumo-Taisha Shrine). Dedicated to the gods Daikokuken and Ebisu, this is a shrine of good fortune and matchmaking.



Doppo-no-Mori Forest (Sakaianya Green Area) 0-1 0-2
This park offers one of the few remaining scenes of thick coppices within the city. With its connections to the novel *Musashino* by Meiji Period literary master Doppo Kunikida, the southern half of the park is known to locals as "Doppo-no-Mori" (Doppo Forest).



Kannon-in Temple 0-3
Matsudaira Naomasa built this temple to Kannon at his *daimyo* summer residence. It later became a temple of the Soto sect. Visitors can experience Zen meditation at the temple.



Musashino Swing Hall 0-3
This concert hall is fully soundproofed by a dual structure. The multi-purpose room is perfect for dances and reception. Conference rooms that can be used as exhibition spaces are also available.



Musashino Furusato History Museum 0-3
This museum features an exhibition room where visitors can learn about the history of Musashino, as well as exhibit rooms for themed exhibits, a "citizens' space" which can be used for historic and cultural educational activities, and collection rooms for the storage and preservation of historic official documents, folk materials, and other valuable items.



Musashino Place 0-3
This multi-functional facility houses a library, a cafe, and functions to support lifelong learning, citizens' activities, and youth activities. In 2016, it received an award from the Architectural Institute of Japan.



QuOLA Musashisakai Civic Center 0-3
The 1st floor of this center houses a cafe, pharmacy, pediatric clinic, and internal medical clinic. The 2nd floor is a complex facility with a civic center, gymnastics classroom for children and senior citizens, and more. The rooftop is available for holding barbecues.

Hours: 9:30-17:00 Closed on Fridays, holidays, year-end/New Year holidays, and other designated days

Food, Dining and Cafe



- 1 Meister Murakami** 0-4
This shop has won multiple international awards since it was founded in Musashino in 1934. It offers ham and sausage with the real taste of Germany. Prepared dishes and cutlet sandwiches are also popular menu items.
3-19-8 Kyonan-cho, Musashino-shi
17:00-25:00 (last order at 24:00)
Closed on Sundays and holidays
TEL: 0422-32-3166
- 2 Pizza & Wine Bar Atom** 0-3
Enjoy a cup of coffee while listening to music and reading the books placed in the shop. Recommended lunch items are the seasonal earthen pot rice dishes and the miso soup, created with miso made in-house.
Sakai Building 1F, 2-2-9 Sakai, Musashino-shi
17:00-25:00 (last order at 24:00)
Closed on Mondays
TEL: 0422-56-2056
- 3 CAFE JI:TA** 0-2
The soup of this ramen is steeped in seafood taste. Enjoy the refreshing and mild flavor drawn from *riboshi* dried fish, along with rich seafood *tsukemen* noodles and *riboshi* ramen.
Dias 1F, 3-12-11 Sakai, Musashino-shi
Tuesday to Thursday: 11:30-19:00
Friday: 11:30-22:00 (16:00-18:00 close)
Saturday: 12:00-22:00
Sunday: 12:00-20:00 (last order 30 minutes before closing)
TEL: 0422-57-3298
Closed on Mondays (No fixed holidays)
- 4 Ramen Kawakiya** 0-4
Hard breads and croissants are popular at this shop. Freshly baked baguettes are ready at 8:00 every morning.
2-13-2 Kyonan-cho, Musashino-shi
11:30-14:30 / 17:30-20:30
No regular closing
Closed at night of Saturdays, Sundays and holidays
TEL: 0422-33-1400
- 5 Passage à niveau** 0-3
The cup of this ramen is steeped in seafood taste. Enjoy the refreshing and mild flavor drawn from *riboshi* dried fish, along with rich seafood *tsukemen* noodles and *riboshi* ramen.
Daiko Building, 1-1-20 Kyonan-cho, Musashino-shi
8:00-17:30 (Finished on a sellout)
Closed on Tuesdays and Wednesdays
TEL: 0422-32-2887



- 6 cafe sacai** 0-3
This cafe boasts a modern and stylish interior space. The menu offers pasta, curry, meat dishes, and other meals, in addition to drinks and sweets. Alcohol is served in the evening.
4-1-16 Kyonan-cho, Musashino-shi
11:00-22:00 (last order at 21:00)
No regular closing
(following day if a holiday)
TEL: 0422-27-8536
- 7 COCKTAIL HAMBURGERS** 0-3
This cafe has an American atmosphere. Because patties use chicken, it is very healthy. Freshly-baked sweet potatoes with sweet sauce is also a popular menu item.
2-1-22 1st Floor Kyonancho, Musashino-shi
Lunch 11:00~15:00
Night 18:00~24:00
No regular closing
TEL: 0422-39-7707
- 8 Café Fermata** 0-3
Breads, sweets, onigiri rice balls, and more appear in the rotating eight shops of this shared kitchen. The painstakingly-made menu items are perfect as gifts. See the links on the 8K website for the business hours of each shop.
Musashino Place 1F, 2-3-16 Kyonan-cho, Musashino-shi
9:30-21:30 (last food order at 20:30, last drink order at 21:00)
Closed on Wednesdays
TEL: 080-3447-3825 (store call phone)
- 9 8K musashisakai** 0-4
Come to this compound shop under the bridge to enjoy heartily hand-made prepared dishes, cakes, coffee, and beer.
Noguchi Store, 3-25-12 Kyonan-cho, Musashino-shi
Business hours and days closed differ by shop.
http://8k-sharekitchen.com/
TEL: 0422-38-5800
- 10 Ond** 0-3
Come to this compound shop under the bridge to enjoy heartily hand-made prepared dishes, cakes, coffee, and beer.
3-2-13 Kyonan-cho, Musashino-shi
Nonomichi Sakai Nish Public Counter: 9:00-21:00 (Weekends, holidays: 10:00-21:00)
markhol DELI: 10:00-21:00
Bateau a tartes: 11:00-21:00
Closed on Wednesdays
TEL: 0422-38-5500



Area Map Explanatory Notes
